

# AKIŞ GÖSTERGESİ SIGHT GLASS (FLOW SCOPE)

ÇİFT CAMLI / FLANŞLI  
DOBLE GLASS / FLANGED

**TİP (TYPE) : BAG - FL**  
**DN 15 - DN 200**

<b>Boyutlar</b>	<i>Dimensions</i>	: EN 558-1
<b>Bağlantılar</b>	<i>Connections</i>	: FLANŞLI / FLANGED PN 16; DIN 2533 // EN 1092-1 FLANŞLI / FLANGED PN 40; DIN 2545 // EN 1092-2
<b>Çalışma Basıncı</b>	<i>Working Pressure</i>	: PN 16 - PN 40
<b>Çalışma Sıcaklığı</b>	<i>Working Temperature</i>	: PN 16 - PN 40 : -30 °C // +180°C
<b>Kullanım Alanları</b>	<i>Usage Areas</i>	: Su, Gıda, Kimya, Hava ve Diğer Gazlar <i>Water, Foodstuffs, Chemistry, Air and Other Gases etc.</i>



MALZEME BİLGİSİ MATERIAL DATA						
PARÇA NO ITEM NO	ADET PCS	PARÇA ADI ITEM DESCRIPTION	MALZEME MATERIAL			
6	8	SOMUN NUT	8	8	8	1.4301
5	8	ÇİVATA BOLT	.8.8	.8.8	.8.8	1.4301
4	4	CAM SIZDIRMAZLIK TEFLONU GLASS TIGHTNESS ELEMENT	PTFE-Teflon	PTFE-Teflon	PTFE-Teflon	PTFE-Teflon
3	2	CAM GLASS	Tem. Glass	DIN 7080	DIN 7080	DIN 7080
2	2	KAPAK COVER	GG 25	GGG 40.3	GS C 25	1.4301 / 1.4401
1	1	GÖVDE BODY	GG 25	GGG 40.3	GS C 25	1.4301 / 1.4401

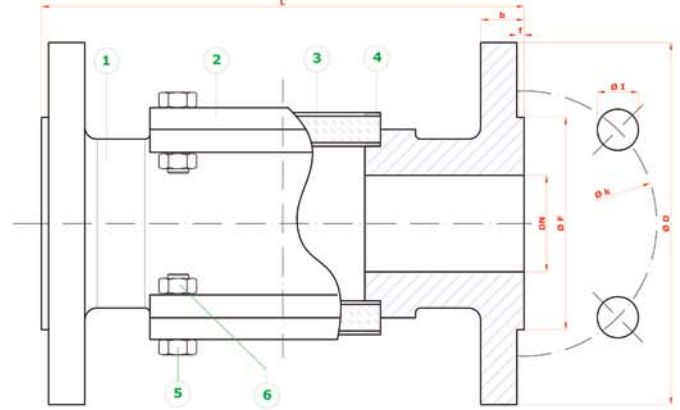

TİP (TYPE)	BOYUTLAR (DIMENSIONS)		BAĞLANTI ÖLÇÜLERİ CONNECTION SIZES															
	PN 16 - 40			PN 16							PN 40							
	L	DN	f	D	k	Hole Unit	I	F	b	kg	D	k	Hole Unit	I	F	b	kg	
<b>BAG-FL</b>																		
<b>DN 15</b>	130	15	2	95	65	4	14	45	14	3,5	95	65	4	14	45	16		
<b>DN 20</b>	150	20	2	105	75	4	14	58	16	4,2	105	75	4	14	58	18		
<b>DN 25</b>	160	25	2	115	85	4	14	68	16	5,6	115	85	4	14	68	18		
<b>DN 32</b>	180	32	2	140	100	4	18	78	18	9,5	140	100	4	18	78	18		
<b>DN 40</b>	200	40	3	150	110	4	18	88	18	14,2	150	110	4	18	88	18		
<b>DN 50</b>	230	50	3	165	125	4	18	102	20	16,0	165	125	4	18	102	20		
<b>DN 65</b>	290	65	3	185	145	4	18	122	20	15,0	185	145	8	18	122	22		
<b>DN 80</b>	310	80	3	200	160	8	18	138	22	19,0	200	160	8	18	138	24		
<b>DN 100</b>	350	100	3	220	180	8	18	158	24	33,0	235	190	8	22	162	24		
<b>DN 125</b>	400	125	3	250	210	8	18	188	26	51,0	270	220	8	26	188	26		
<b>DN 150</b>	350	150	3	285	240	8	22	212	26	56,5	300	250	8	26	212	28		
<b>DN 200</b>	400	200	3	340	295	12	22	268	30	83,5	375	320	12	30	285	34		
<b>DN 250</b>	650	250	3	405	355	12	26	320	32	195,0	450	385	12	30	345	38		
<b>DN 300</b>	750	300	4	460	410	12	26	378	34		515	450	16	33	410	42		

BATUSAN standartlar içerisinde kalarak; dizayn, konstrüksiyon ve malzeme değiştirme hakkına sahiptir.  
BATUSAN has rights to change for desing, construction and material of it's products with respect to standards